

Toggle fixings K, KD, KDH, KDR, KM

The powerful and universal fixing for cavity-space fixing.

OVERVIEW



Toggle fixings
K, KD, KDH, KM

KDR

Suitable for:

- Prestressed hollow-core concrete slabs
- Gypsum plasterboard and gypsum fibreboards
- Chip boards and slabs made of perforated bricks
- Hollow concrete blocks etc.



For fixing of:

- Pictures
- Lamps
- Electric switches
- Key boxes
- Small wall-mounted shelves
- Towel rails
- Lightweight mirror cabinets
- Curtain rails
- Cable and pipe clips
- Cable trays

DESCRIPTION

Nylon toggle K 54

- Cavity fixing with a tilting crosspiece for woodscrews, 4 mm diameter

Spring toggle KD/ KDH 3/4

- Expands by spring force into any cavity.

Gravity toggle KD/ KDH 5/6/8

- Has a tilting crosspiece which automatically locks itself in cavities.

KM 10

- Specially designed for fixing washstands and urinals to plumbing units and cavity walls.

Advantages/benefits

- Surface-flush Nylon toggle K54 allows the attached item to be removed and refitted several times.
- KD and KDH toggles are specially designed for small cavity depths.
- All KD and KDH are fully zinc-plated and yellow chromated for good corrosion protection.
- Long threaded rods allow large wall thicknesses to be bridged.

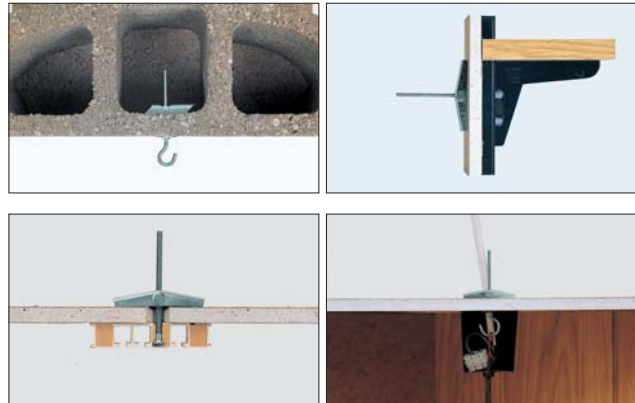

INSTALLATION

Type of installation

- Pre-positioned installation

Installation tips

- Observe the cavity depth and board thickness (see the table).
- KD 5 to 8, KDH 5 to 8 and KM 10 toggles cannot be installed pointing downwards (e.g. floor).

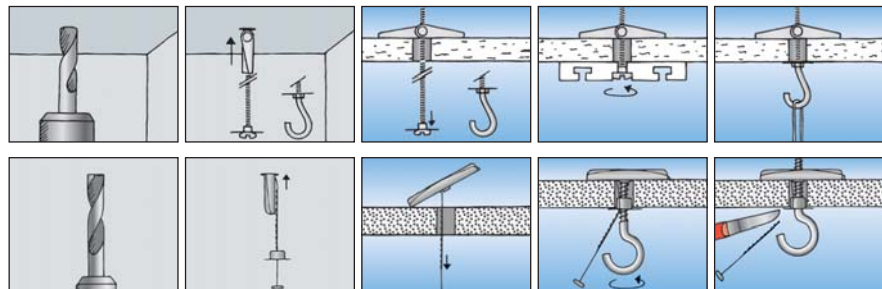

FIXING PRINCIPLES

In detail: The general principles for installation, the correct drilling procedure and much more on page 26.

TECHNICAL DATA

Nylon toggle **K 54**



Type	Art.-No.	ID	drill	max. panel thickness	min. cavity depth	anchor length	thread	qty. per box
			d_0 [mm]	d_p [mm]	a [mm]	l [mm]	M	
K 54	50323	2	10	65	58	125	woodscrew 4mm	25

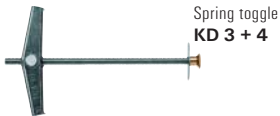

Spring toggle **KD 3 + 4**



Spring toggle **KDH 3 + 4**



Spring toggle **KDR 4**

Type	Art.-No.	ID	drill	max. panel thickness	min. cavity depth	anchor length	thread	Qty. per box
			d_0 [mm]	d_p [mm]	a [mm]	l [mm]	M	
KD 3	80181	9	12	65	27	95	M 3 x 90	50
KDH 3	80182	6	12	51	27	105	M 3 x 80	25
KD 3 B	80192	5	12	65	27	95	M 3 x 90	10
KD 4	80183	3	14	69	34	105	M 4 x 100	25
KDH 4	80184	0	14	35	34	95	M 4 x 70	25
KD 4 B	80193	2	14	69	34	105	M 4 x 100	10
KDR 4	26437	9	14	35	34	95	M 4 x 70	25

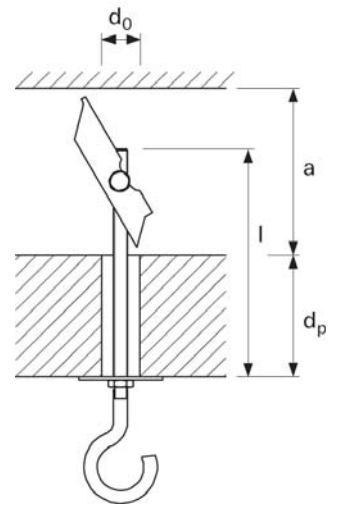

Cavity fixings



Gravity toggle **KD 5 + 6 + 8**



Gravity toggle **KDH 5 + 6 + 8**



Gravity toggle **KDR 5 / KDR 6**

Type	Art.-No.	ID	drill	max. panel thickness	min. cavity depth	anchor length	thread	Qty. per box
			d_0 [mm]	d_p [mm]	a [mm]	l [mm]	M	
KD 5	80187	1	16	63	70	100	M 5 x 100	25
KDH 5	80188	8	16	60	70	130	M 5 x 90	20
KDR 5	26438	6	16	35	70	130	M 5 x 70	20
KD 6	80185	7	16	63	70	100	M 6 x 100	25
KDH 6	80186	4	16	60	70	130	M 6 x 100	20
KDR 6	26439	3	16	35	70	130	M 6 x 100	20
KD 8	80178	9	20	55	75	100	M 8 x 100	20
KDH 8	80179	6	20	55	75	130	M 8 x 100	20

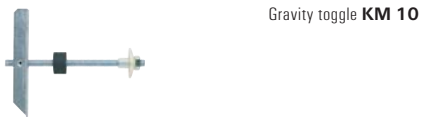

Gravity toggle **KM 10**

Type	Art.-No.	ID	drill-Ø	max. panel thickness	min. cavity depth	anchor length	screw	Qty. per box
			d_0 [mm]	d_p [mm]	a [mm]	l [mm]	$d_s \times l_s$ [mm]	
KM 10	50326	3	30	90	140	240	M 10 x 180	25

LOADS

Recommended loads F_{rec} [kN] (F_{rec} includes safety factor 4)

K 54 *	failure of the nylon thread	0,11
KD 3		0,14
KD 4		0,29
KD 5		0,43
KD 6		0,50
KD 8		1,93
KM 10		1,86

* safety factor 7

Recommended loads F_{rec} [kN] (F_{rec} includes safety factor 4)

KDH 3 **	the hook bends open	0,05
KDH 4 **		0,20
KDH 5 **		0,30
KDH 6 **		0,50
KDH 8 **		0,75

** safety against bend open.